	<b>Business Management System</b> Transformer and Switchgear Services Insulation List	Document Identifier	240-94063528	Rev	1
		Effective Date	17/10/2018		
		Review Date	17/10/2021		
		Page	1 of 2		

DATE: 10/09/2020

REPLY TO: ESTIMATORS

Compile By : N.L. MAPIMELE

Verify By : K Hoffmann

Signature : 

Signature : 

DEAR SIR/MADAM

PROJECT NUMBER: 2.KMDM

SERIAL NUMBER: ET9495/A

HEREWITH, PLEASE FIND THE WINDING MATERIAL QUOTE REQUEST LIST

TRANSFORMER WINDING MATERIAL QUOTE REQUEST LIST			
QUANTITY PER PHASE	QUANTITY PER TRANSFORMER	UNIT	DESCRIPTION
			<b><u>A. WINDING</u></b>
1	3		Cylinder ID846/OD856 x L2790mm. Pre stabilized cylinder. Tolerance 2mm over on circumference no under. Overlap to be 90 - 100mm. Use Kasein glue on joint/s.
32	96		T. Stick T8mm x W26.5mm x L2720mm
11 040	33 120		Punched or Machine Clacks <b>AS PER DWG No. EE04D/15/0280</b>
5	17		Oil Guide Rings, ID858 / OD872 x H12mm
	3		High density board T1mm x 2100mm x 3100mm
	2		High density board T2mm x 2100mm x 3100mm
	3		High density board T3mm x 2100mm x 3100mm
	4		High density board T8mm x 2100mm x 3100mm
	3		High density board T10mm x 2100mm x 3100mm
1	3		Inner yoke collar 21-1: T2mm x ID868/OD915 x H150mm x Radius 8mm
2	1 SET (6 off)		Ring <b>AS PER DWG NO.: EE04D/16/0004</b>
	5		Reinforced glass tape width 20mm x 100Meters/roll
	1		Kasein glue 33kgs. Manufacture date + expiry date to be on container.
	25		<b>Crepe Tape 12HCC or HDC Reinforce paper</b> Thickness 0.056mm x 16mm x 100m per roll
2	6		Static Ring, as per <b>DWG No. EE04D/20/0089</b>

**Controlled Disclosure**

When downloaded from the document management system, this document is uncontrolled and the responsibility rests with the user to ensure it is in line with the authorised version on the system.

No part of this document may be reproduced without the expressed consent of the copyright holder, Eskom RoteK Industries SOC Ltd.

	<b>Business Management System</b> Transformer and Switchgear Services Insulation List	Document Identifier	240-94063528	Rev	1
		Effective Date	17/10/2018		
		Review Date	17/10/2021		
		Page	2 of 2		

			<b><u>C. WINDING</u></b>
1	3		Cylinder ID1590/OD1594 x L2455mm. Pre stabilized cylinder. <u>Tolerance 2mm over on circumference no under. Overlap to be 120 - 150mm.</u> Use Kasein lim glue on joint/s.
1	3		<b>Open</b> Cylinder ID1614/OD1624 x L2420mm. Pre stabilized cylinder. <u>Overlap to be 120 - 150mm.</u>
32	96		T. Stick T10mm x W26.5mm x L2420mm
4 800	14 400		<b>Punched or Machine Clacks AS PER DWG No. EE04D/15/0280</b>
2	6		Inner yoke collar 21-1: T4mm x ID1604/OD1695 x H150mm x Radius 13.5mm
1	3		Top Static Ring, as per <b>DWG No. EE04D/20/0089</b>
1	3		Bottom Static Ring, as per <b>DWG No. EE04D/20/0089</b>
1	3		Rings <b>AS per DWG No. EE04D/16/0004</b>
	45		<b>Crepe Tape 12HCC or HDC Reinforce paper</b> Thickness 0.056mm x 16mm x 100m per roll
	3		Reinforced glass tape width 20mm x 100Meters/roll
	2		High density board T10mm x 2100mm x 3100mm
	2		High density board T8mm x 2100mm x 3100mm
	2		High density board T2mm x 2100mm x 3100mm

**NOTE: Revision 1, Clack strips changed to punched or machine clacks**

**Controlled Disclosure**

When downloaded from the document management system, this document is uncontrolled and the responsibility rests with the user to ensure it is in line with the authorised version on the system.

No part of this document may be reproduced without the expressed consent of the copyright holder, Eskom RoteK Industries SOC Ltd.

Hard copy printed on: 22/03/2022

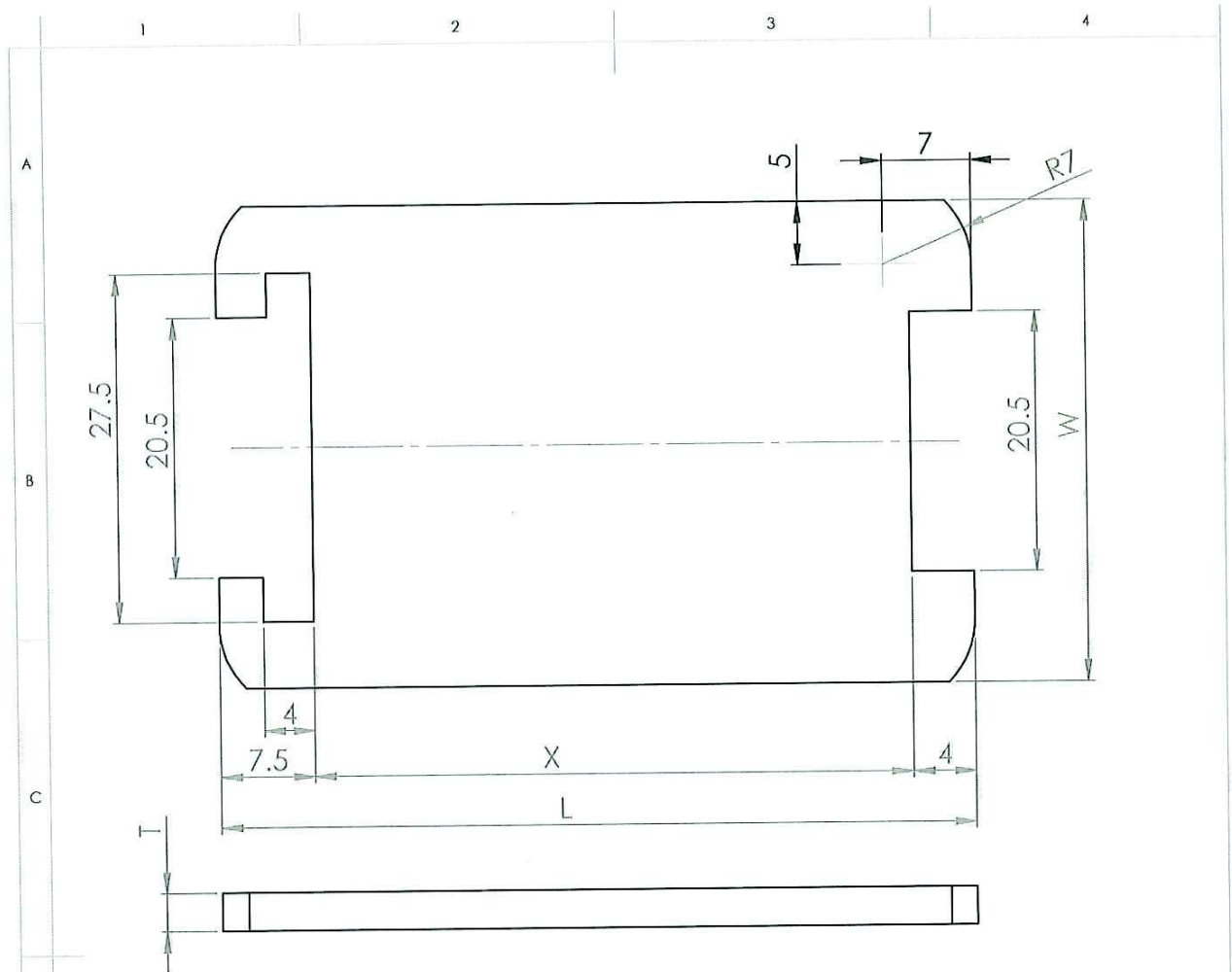

WINDING	THICKNESS (T)	LENGTH (L)	WIDTH (W)	X	No. OFF	No. PER RIB
A/W	3	35.5	35	24	33 120	345
C/W	3	39.5	55	28	14 400	150

UNLESS OTHERWISE SPECIFIED: DIMENSIONS ARE IN MILLIMETERS		FINISH:		DEBUR AND BREAK SHARP EDGES		DO NOT SCALE DRAWING		REVISION		0	
SURFACE FINISH:											
TOLERANCES:											
LINEAR:						<b>CLACK</b>					
ANGULAR:											
DRAWN	NAME	SIGNATURE	DATE	PROJECT No:	<b>CLACK</b>						
CHK'D	SD MATLABE		2015/11/03	SERIAL No:							
APPVD	NL MAPIMELE		2015/11/03	FROM:							
				TYPE:							
				MATERIAL:		DWG NO.				A4	
				T4/HD ELBOARD		EE04D/15/0280					
				WEIGHT:		SCALE: 1:1				SHEET 1 OF 1	

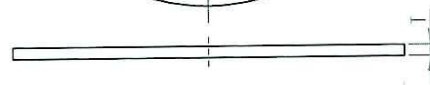
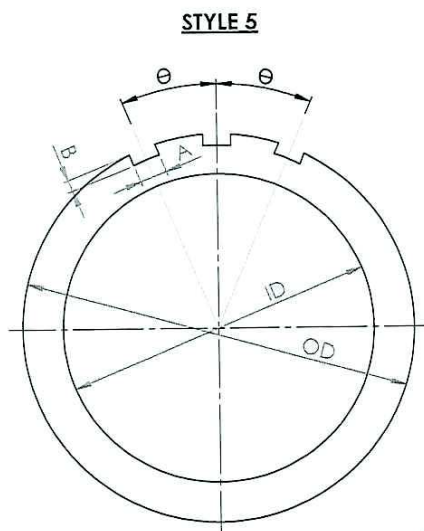
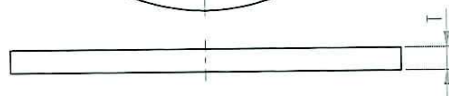
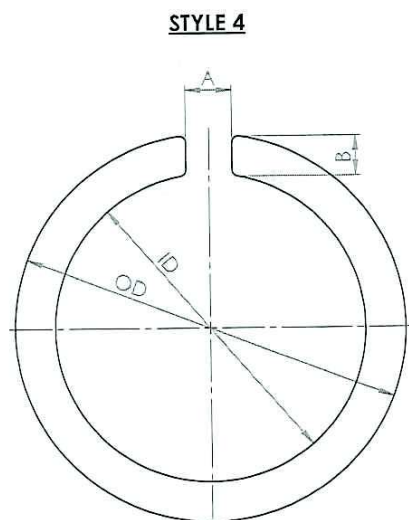
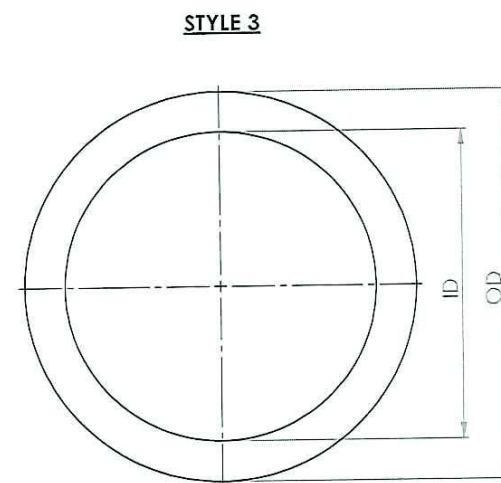
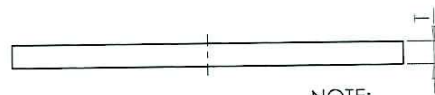
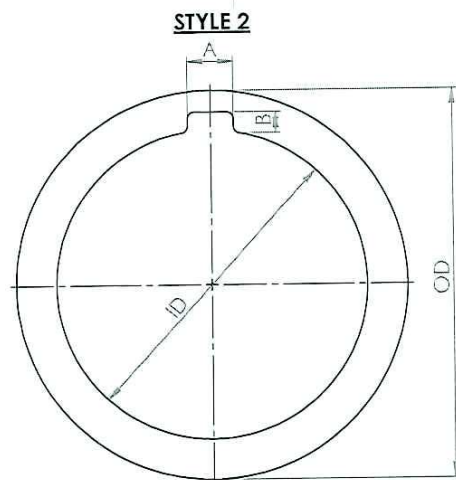
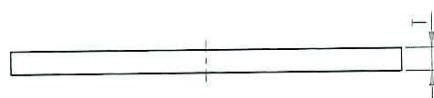
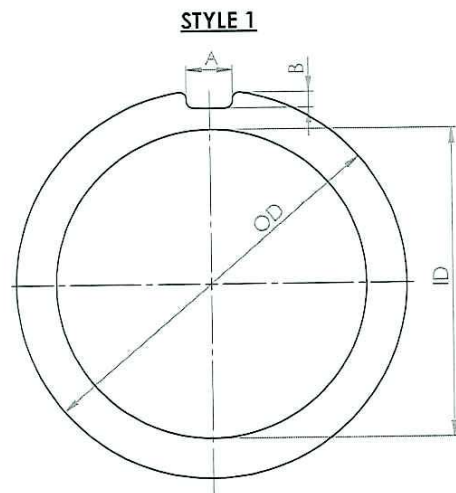

NOTE:

1. MINIMUM CORNER RADIUS  $R=2\text{mm}$
2. STYLE 5 SLOTS TO BE AROUND THE WHOLE RING(EQUALLY SPACED).

[illegible]

UNLESS OTHERWISE SPECIFIED:  
DIMENSIONS ARE IN MILLIMETERS  
SURFACE FINISH:  
TOLERANCES:  
LINEAR:  
ANGULAR:

FINISH:

DEBUR AND  
BREAK SHARP  
EDGES

DO NOT SCALE DRAWING

REVISION 0



	NAME	SIGNATURE	DATE
DRAWN	SD MATLABE		2016/01/1
CHK'D	NL MAPIMELE		
APP'VD			

CHRD	N
APPVD	

SIGNATURE	DATE
-----------	------

PROJECT No:	2.KMDM
SERIAL No:	EP9495/A
TYPE:	A/W
FROM:	GERUS

MATERIAL:

T4 TRANSFORMER BOARD

WEIGHT:

	TITLE
1	
2	
3	
4	
5	
6	
7	
8	
9	
10	
11	
12	
13	
14	
15	
16	
17	
18	
19	
20	
21	
22	
23	
24	
25	
26	
27	
28	
29	
30	
31	
32	
33	
34	
35	
36	
37	
38	
39	
40	
41	
42	
43	
44	
45	
46	
47	
48	
49	
50	
51	
52	
53	
54	
55	
56	
57	
58	
59	
60	
61	
62	
63	
64	
65	
66	
67	
68	
69	
70	
71	
72	
73	
74	
75	
76	
77	
78	
79	
80	
81	
82	
83	
84	
85	
86	
87	
88	
89	
90	
91	
92	
93	
94	
95	
96	
97	
98	
99	
100	

## WINDING RINGS

	DWG NO.
--	---------

EE04D/16/0004

A3

SCALE 1:2

SHEET 1 OF 1

WINDING	BARE LEAD AREA (mm <sup>2</sup> )	SHIELD CORE DIMENSION							COVERED SHIELD (FINAL DIMENSION)					No Off
		ID	OD	A	B	C	R	thick	ID	OD	A	B	C	
A/W	16	881	909	34	16	66	5	14	875	915	40	22	60	6
C/W TOP	16	1652	1688	206	82	390	20	20	1644	1696	214	90	382	3
C/W BOT	16	1652	1688	202	78	390	20	20	1644	1696	210	86	382	3

**NOTE:**

1. Supply to manufacture according to their own standard / procedure and **Lanband** to be used.
2. All Radii are 2mm unless otherwise stated.
3. Lead to be 600mm long flexi cable.
4. Groove size to accommodate the flexi cable with the minimum length of 100mm.

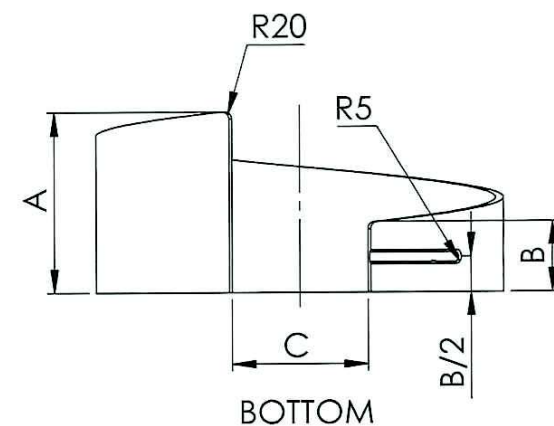
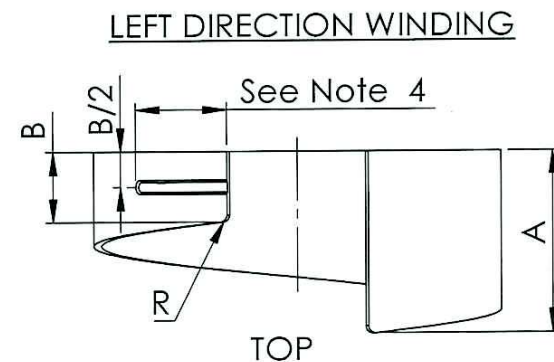

UNLESS OTHERWISE SPECIFIED: DIMENSIONS ARE IN MILLIMETERS SURFACE FINISH: TOLERANCES: LINEAR: ANGULAR:				FINISH:		DEBUR AND BREAK SHARP EDGES		DO NOT SCALE DRAWING		REVISION	
DRAWN: MS MOGANO				SIGNATURE: [Signature]		DATE: 2021/09/06		PROJECT No: 2.KMDM		TITLE:	
CHK'D: NL MAPIMELE				SIGNATURE: [Signature]		DATE: 2021/09/06		SERIAL No: ET9495/A		HELICAL TYPE SHIELD RING	
APPV'D: Igor Myagkov				SIGNATURE: [Signature]				TYPE:			
MFG:								FROM: GERUS			
Q.A: DWG NO.								MATERIAL: TRANSFORMER BOARD TIV		DWG NO. EE04D/20/0089	
SCALE: 1:10								WEIGHT:		SHEET 1 OF 1	

A4